

# Floor Plan Version 1

392 Beverley Road Flat 3 , Hull, England HU5 1LS

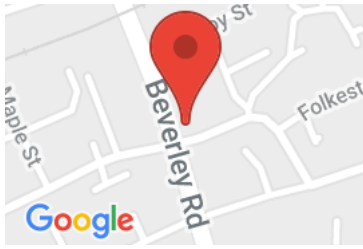

## Statistics

Area: 36 m<sup>2</sup>  
Living area: 44 m<sup>2</sup>  
1 Floor  
1 Bedroom  
1 Bathroom



## Ground Floor

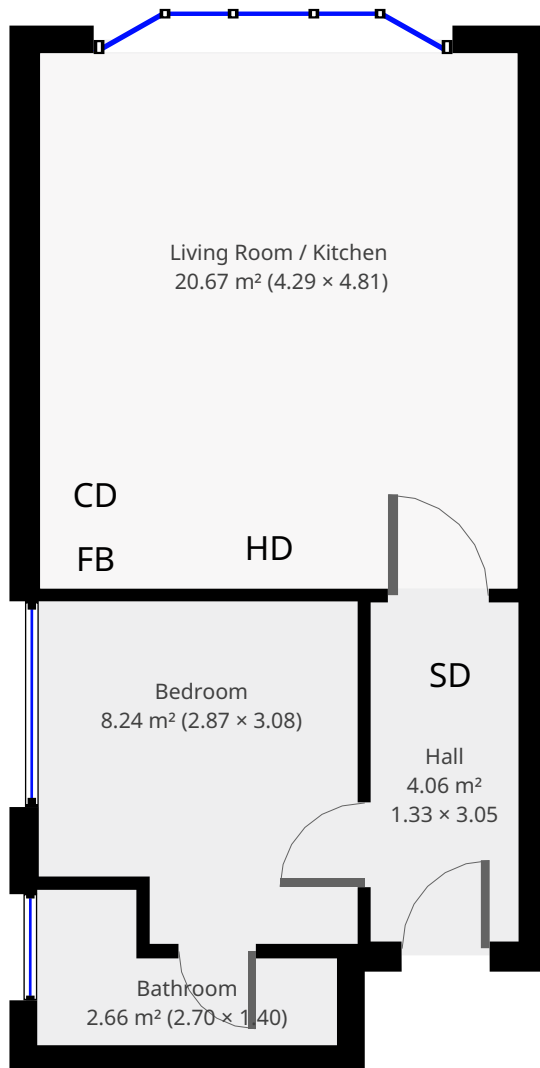

HD - Heat Detector  
SD - Smoke Detector  
FB - Fire Blanket  
CD - Carbon Monoxide Detector