

Floor Plan Version 1

393 Beverley Road Flat 1, Hull, England HU5 1LS

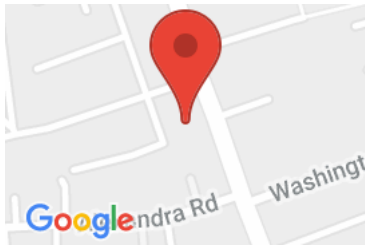

Statistics

Area: 35 m²
Living area: 44 m²
1 Floor
1 Bedroom
1 Bathroom



Ground Floor

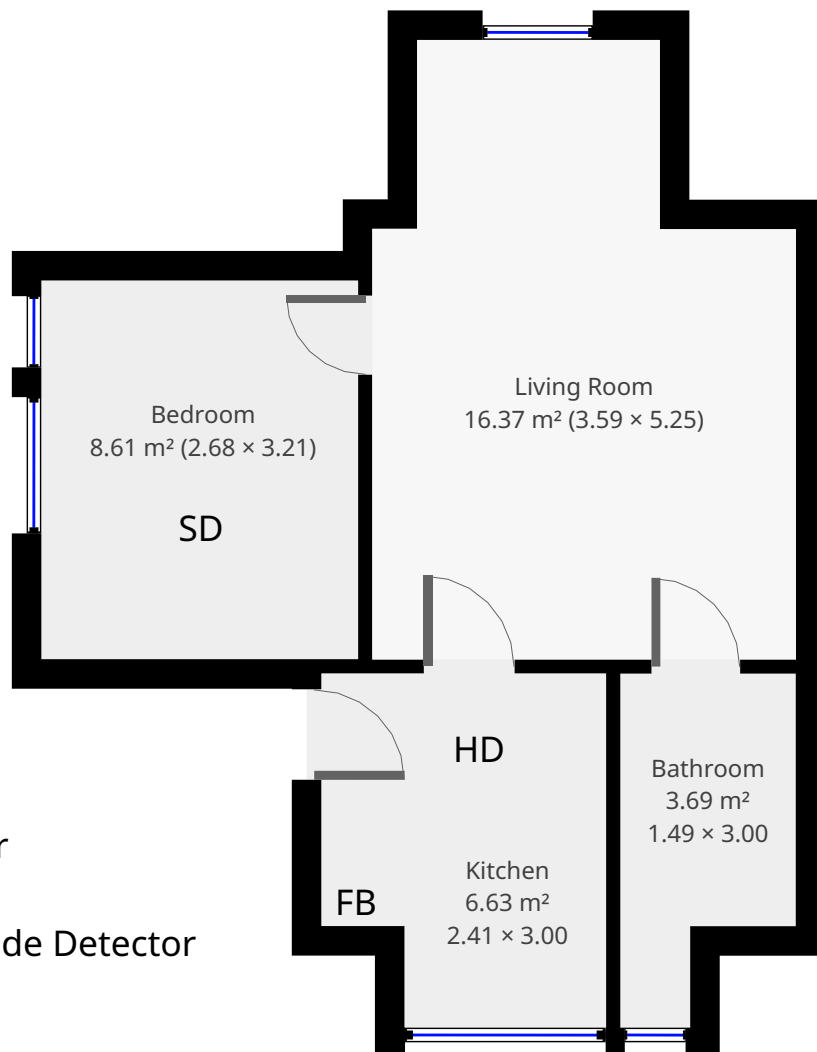

HD - Heat Detector
SD - Smoke Detector
FB - Fire Blanket
CD - Carbon Monoxide Detector