

Floor Plan - 14/02/2018

389 Beverley road, Hull, England HU5 1LS



Statistics

Area: 296 m²
Living area: 356 m²
3 Floors
10 Bedrooms
11 Bathrooms



Ground Floor

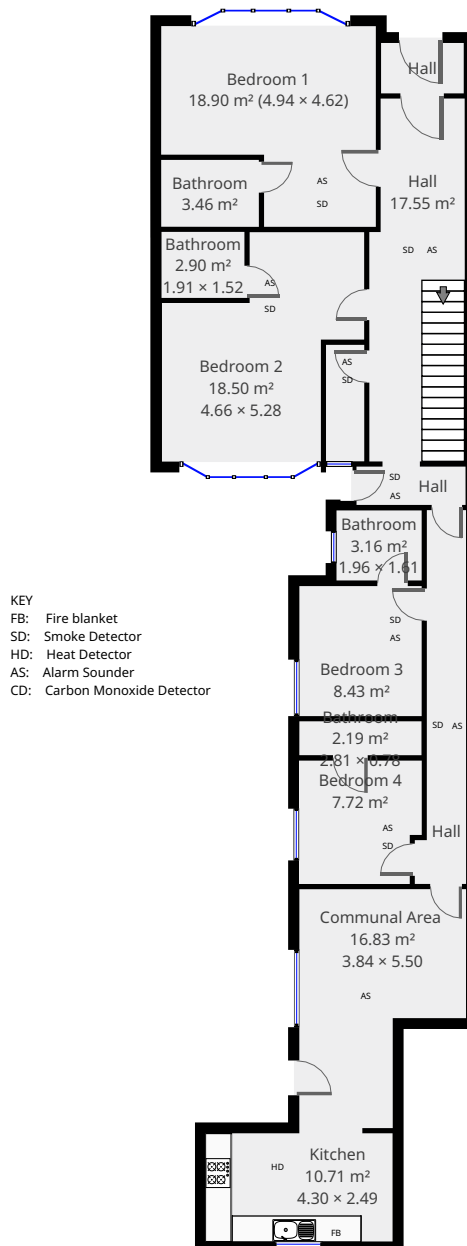

Floor Plan - 14/02/2018

389 Beverley road, Hull, England HU5 1LS



Statistics

Area: 296 m²
Living area: 356 m²
3 Floors
10 Bedrooms
11 Bathrooms



1st Floor

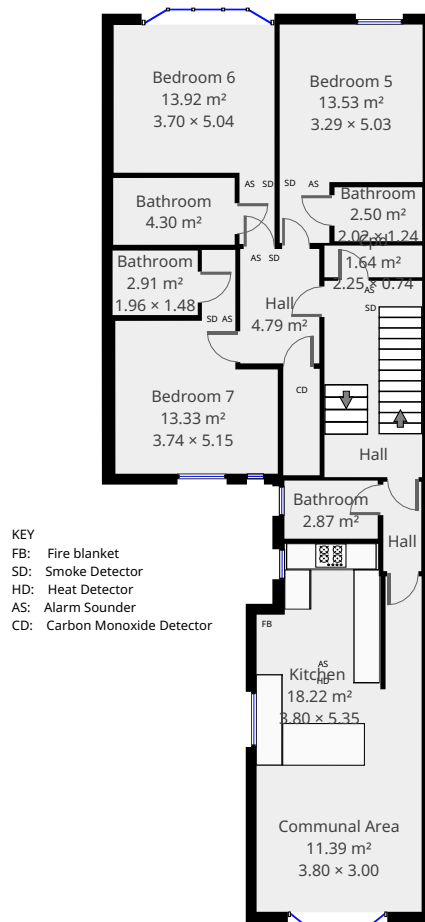

Floor Plan - 14/02/2018

389 Beverley road, Hull, England HU5 1LS

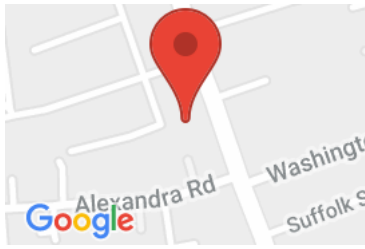

Statistics

Area: 296 m²
Living area: 356 m²
3 Floors
10 Bedrooms
11 Bathrooms



2nd Floor

