

Floor Plan Version 1

115-117 Beverley road Flat 7, Hull, England HU3 1TS



Statistics

Area: 62 m²
1 Floor
2 Bedrooms
1 Bathroom



1st Floor

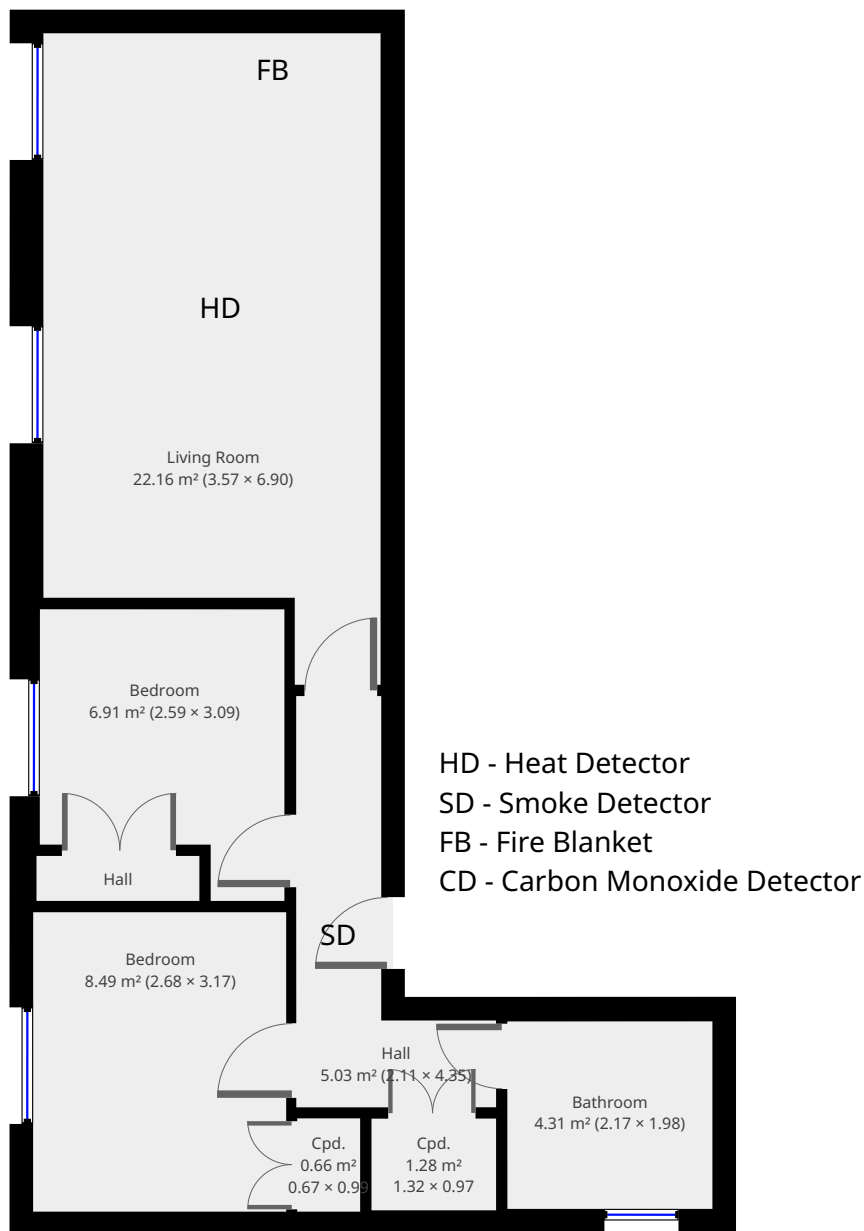

This floor plan is provided without warranty of any kind. EPC247 Disclaims any warranty including, without limitation, satisfactory quality or accuracy of dimensions.