

Floor Plan Version 1

115-117 Beverley road Flat 5, Hull, England HU3 1TS



Statistics

Area: 74 m²
1 Floor
2 Bedrooms
1 Bathroom



Ground Floor

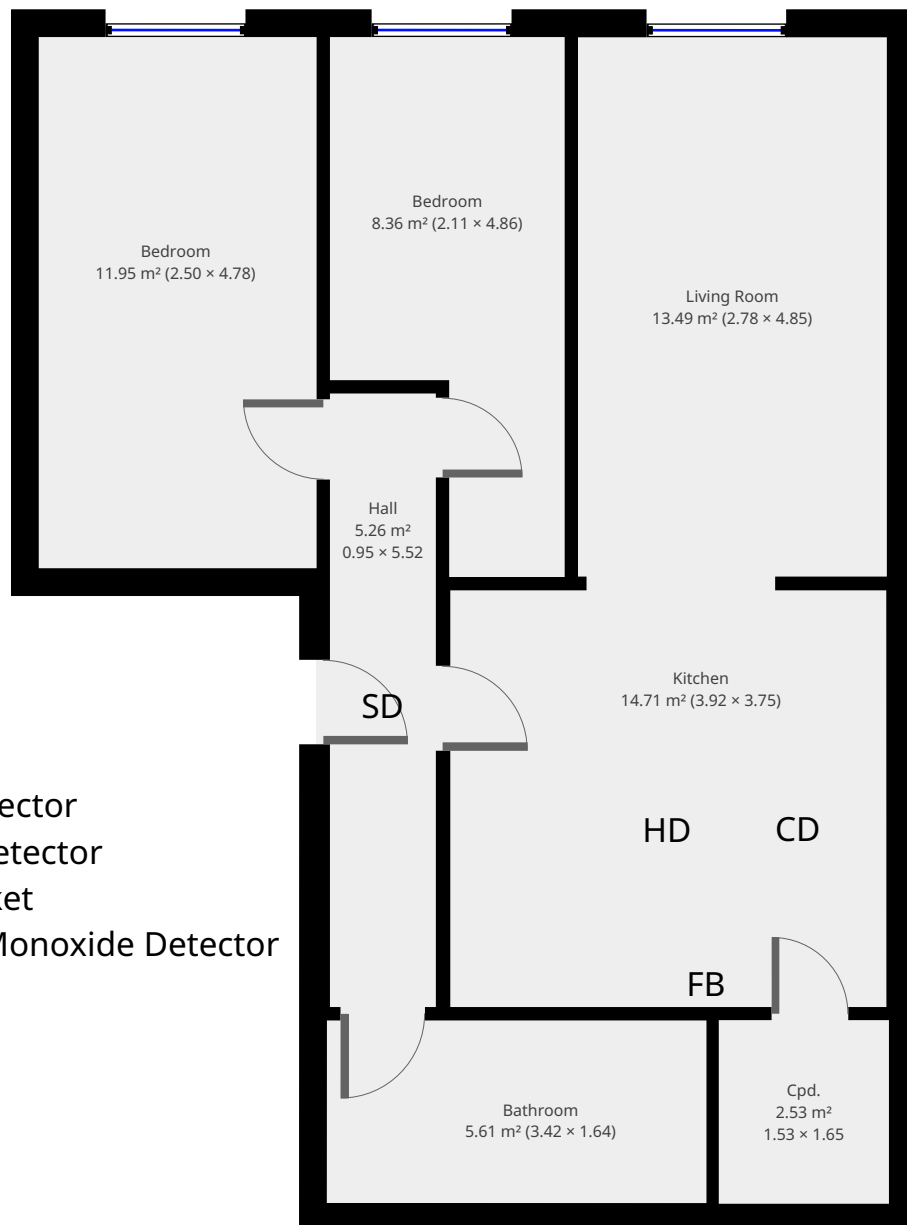

HD - Heat Detector
SD - Smoke Detector
FB - Fire Blanket
CD - Carbon Monoxide Detector